

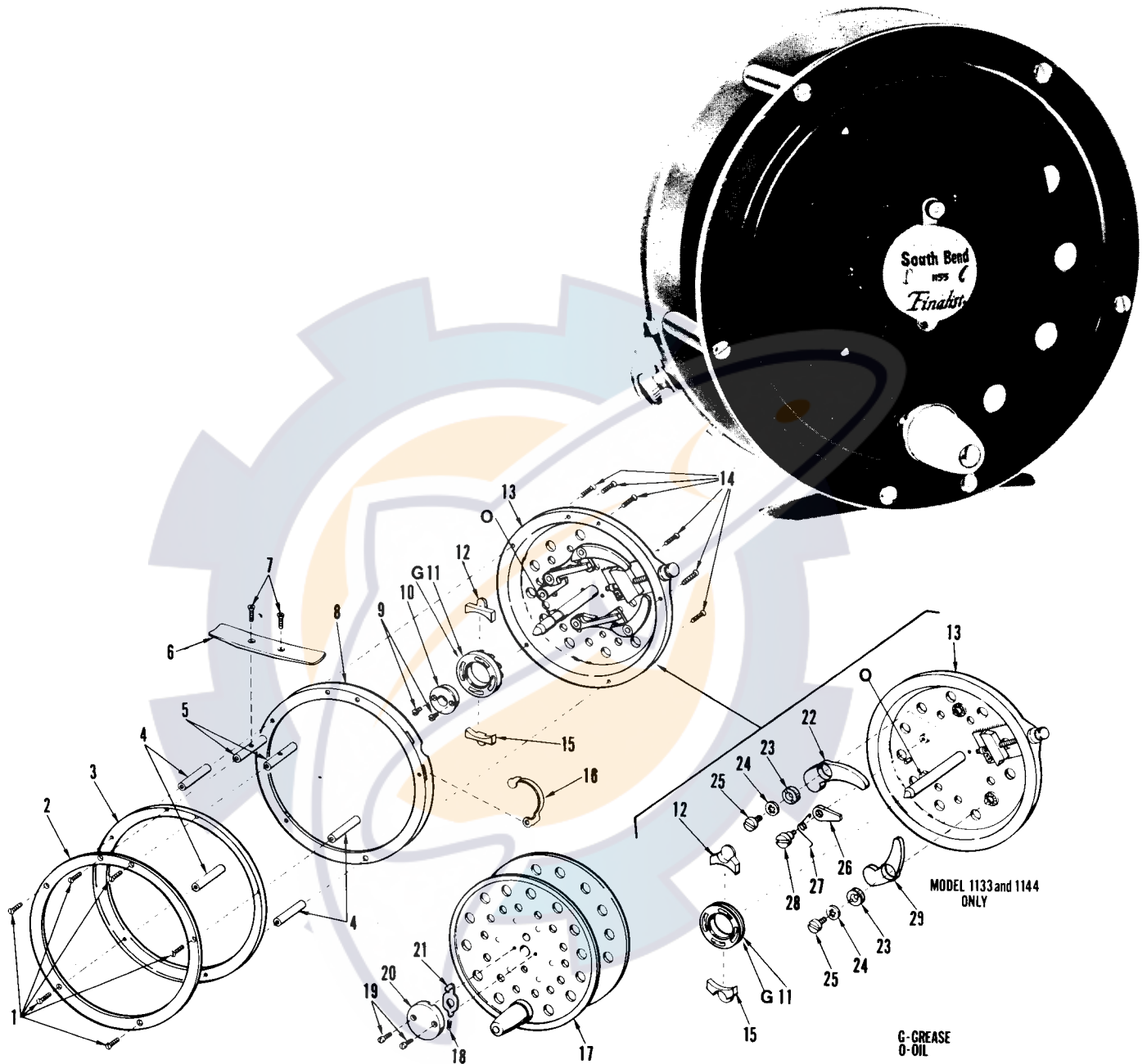

**GLADDING**  
**South Bend Tackle Co., Inc.**  
 Division of **GLADDING** Corporation

**1155**  
 3-31-1155  
**FLY REEL**



MODEL 1133 and 1144 ONLY

G-GREASE  
 O-OIL

| Detail No. | Part Name          | Part No.   | Price | Detail No.  | Part Name   | Part No.  | Price |
|------------|--------------------|------------|-------|---|-------------|-----------|-------|
| 1          | Pillar Screws      | SA22-55/8  | .10   | 17  | Spool Assy  | SA56-551  | 4.95  |
| 2          | Front Plate        | SA25-55/6  | 1.45  | 18  | Lock Spring | SA19-55/3 | .20   |
| 3          | Front Ring         | SA28-55/7  | 1.60  | 19  | Cap Screws  | SA1-55/5  | .10   |
| 4          | Side Pillars       | SA30-55/9  | .30   | 20  | Spool Cap   | SA67-55/4 | .25   |
| 5          | Bottom Pillars     | SA32-55/10 | .30   | 21  | Spool Lock  | SA4-55/2  | .15   |
| 6          | Rod Clips          | SA34-55/11 | .90   | COMPLETE FRAME ASSEMBLY *<br>with Center Post, Click Pawl,<br>Phenolic-Teflon Brake Seats, 1st<br>and 2nd Stage Arms, Brake Arm<br>Rivets Drag Screw Retainer,<br>Drag Screw Retainer Rivets,<br>Drag Screw. Plastic Washer,<br>Double Action Cam, 1st and<br>2nd Stage Levers. (Latter parts<br>are riveted and are not available<br>separately as spare parts.) |             |           |       |
| 7          | Rod Clip Screws    | SA35-55/12 | .10   | 55/21   |             | 11.50     |       |
| 8          | Back Ring          | SA38-55/16 | 1.60  |   |             |           |       |
| 9          | Drag Hub Screws    | SA39-55/13 | .10   |   |             |           |       |
| 10         | Drag Hub           | SA40-55/14 | .70   |   |             |           |       |
| 11         | Drag Drum          | SA42-55/15 | .50   |   |             |           |       |
| 12         | Drag Pad-1st Stage | SA44       | 1.10  |   |             |           |       |
| 13         | Back Plate B       | SA47       | *     |   |             |           |       |
| 14         | Back Plate Screws  | SA49-55/8  | .10   |   |             |           |       |
| 15         | Drag Pad-2nd Stage | SA51       | .60   |   |             |           |       |
| 16         | Knob Guard         | SA53-55/19 | .30   |   |             |           |       |